



N18873

Raex

CURTAIN TRACK MOTOR

M500 System Specifications



Please read the specifications carefully BEFORE installation or use.
This system can only be installed by an electrician and qualified track installer.

windoware
designer collection

Attention:

1. The installation and limit adjustments must be done by a professional curtain track installer.
2. Do not install this system outside or in direct sunlight
3. Never attempt to repair or alter the motor.
4. Never add lubricant to the drive as the system has a lubricated design.

Characteristics:

- Quiet, stable and strong
- Perfect insulation and thermal overload protection
- Built-in receiver, direct connection with AC power
- Made from quality materials
- Stable speed and exact limit setting
- 45kg individual/90kg load capacity (with double drives)
- Intelligent exterior port connection, enables connections to computer system
- 13m Long track range (straight or curved)
- Use with 7 channel remote control
- Fully patented

Motor Specifications:

Type:	M500
Voltage (v):	230v
Frequency (Hz):	50/60
Power (w):	45 watt
Torque (Nm):	1.2
Speed (rpm):	88.6
Insulation Class:	I.cl.E
Overheating Protection:	6min
Protection Index:	IP41

Specifications:

Track Componentry Diagram

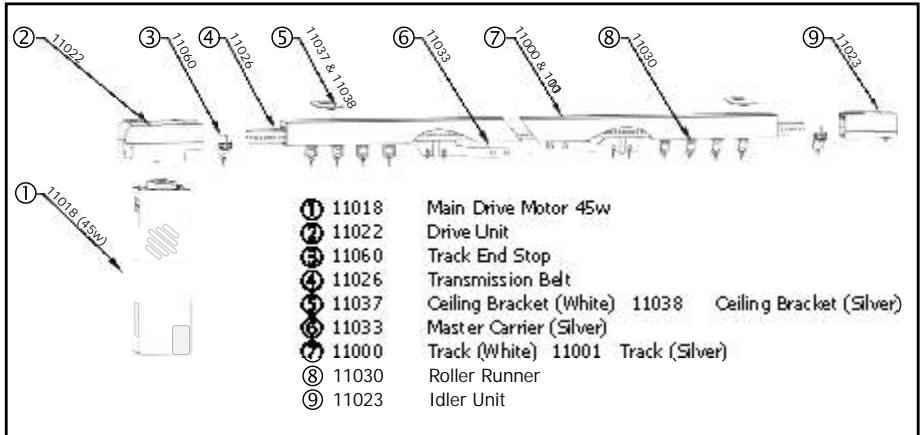

Motor Dimensions



System Connection:

Motor/track Allowances

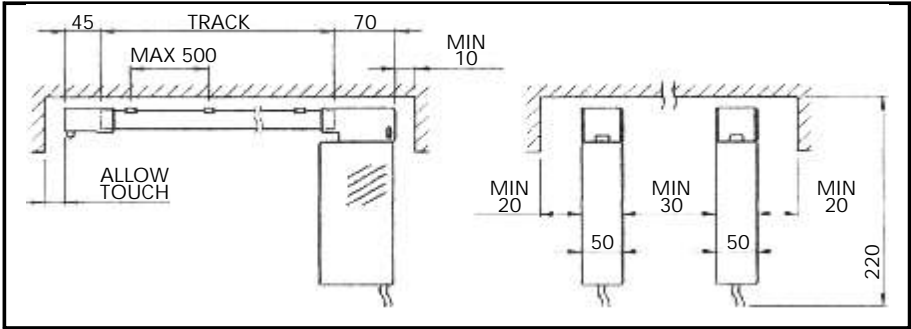

Motor Connecting to BUS line

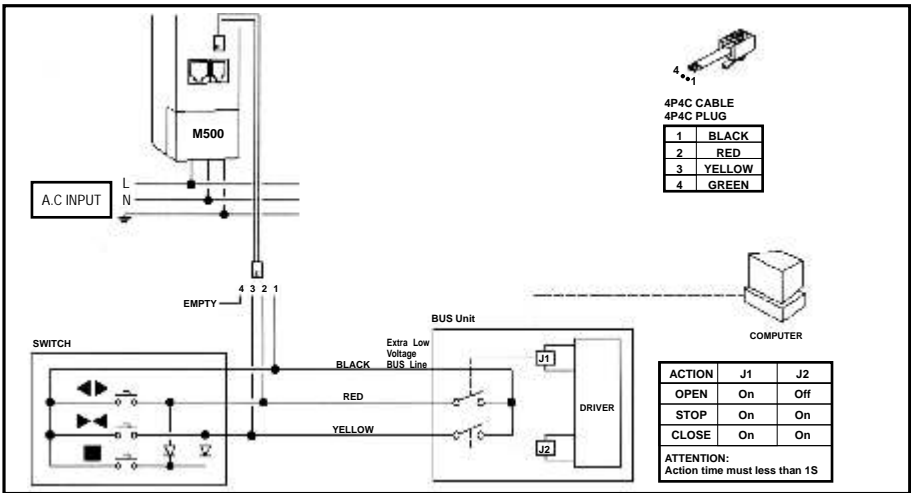



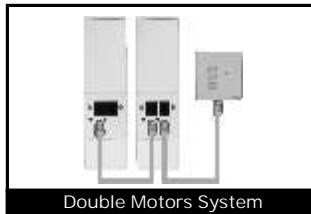

For Connecting M500 Motors To Wall Switches



Remote Setting:

Button Functions

- [UP]  Open the curtain
- [STOP]  Midway Stop
- [DOWN]  Close the curtain
- [CHANNEL CHOOSE]  Choose corresponding channel by pressing buttons
- [CHANNEL SETTING]  Set the remote channel

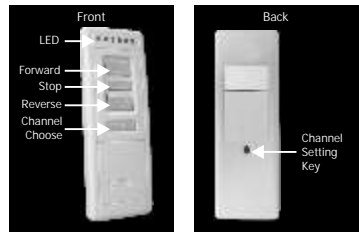

7 Channel Remote Control

1) Add a New Remote Channel Setting:

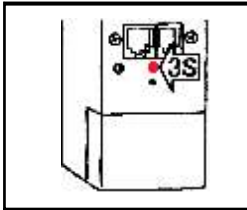

1a. Press "learning-key" for 3sec until the indicator light is on.

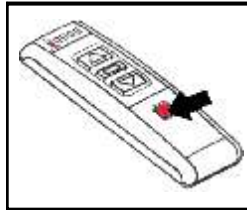

1b. Choose a channel which you want to add.



1c. Press "channel-setting" key. The red light will then flash on the motor, you must then press again until it goes off.

2) Delete all Remote Control Settings:

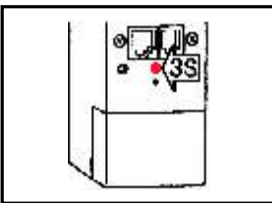

2a. Press "learning-key" for 3sec until the indicator light is on.

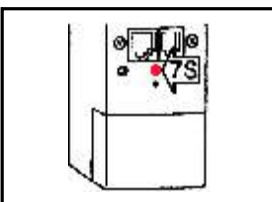

2b. Press "learning-key" again for 7sec until the indicator light flashes and then goes off.

3) Correct the Direction:

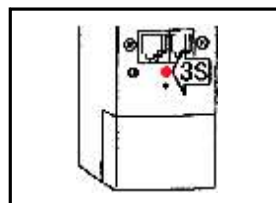

3a. Press "learning-key" for 3sec until the indicator light is on.

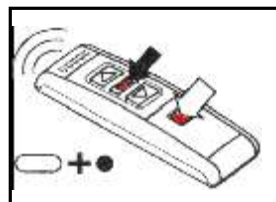

3b. Press "select", and press "stop" together and hold for 2-3 seconds.

Limit Settings:

PLEASE NOTE: M500 is an AC motor with a built in transformer and remote receiver. The installation must be completed by a qualified Electrician. All limits and channel set up modes will be completed by an installer. At no time should users attempt to change electrical wiring or alter curtain limits without contacting an electrician or curtain installer.

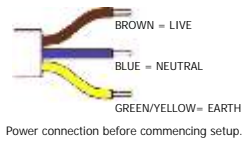

1. Install the motor on the track and click on. Plug connection must face in.



2. Remove cover by pushing in small hole with a paper clip or pin.

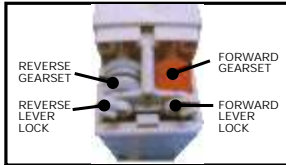

3. Functions/ Red forward, grey reverse (May have opposite function depending on track set up). This can be reversed, see previous page.



4. Now select the channel required for that track. Ensure the remote is tuned to the motor see previous page.



5. Push the forward and reverse levers locks inside, turn all wheels to the two fine lines = and they will click.



6. Press the Forward direction on the (remote) first. Then turn the bottom wheel slightly (Red forward) and the carrier will move. When it arrives in the correct position remove your finger from the wheel and the carrier will stop...

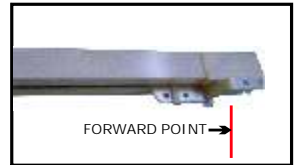

7. ...when the carrier arrives at the required stop position...



8. ...Push the forward lever on the red wheel to the outside. This locks and sets the forward setting.



9. Press the Reverse direction on the (remote) first. Then turn the bottom wheel slightly (Grey wheel) and the carrier will move. When it arrives in the correct position remove your finger from the wheel and the carrier will stop...



10. ...when the carrier reaches reverse point required.



11. Push the reverse lever lock to the outside.



12. Replace the under-cover. Note: cover cannot be replaced unless the lever locks are in the locked outside position.

PLEASE NOTE:

A) With the tandem motor system, you can only set the travel on the main motor. The assistant motor always works in-phase with the main motor. B) Directions can be swapped if required.

Troubleshooting:

Malfunction	Reason	How to Rectify
Both motor and the light are off	No power	Check the power supply
Light is on, but motor has no movement	Limit setting error	Re-set the limits
Remote control does not work	Incorrect channel setting	Reset the remote control channel
	Remote light dim	Change the batteries
	Distance too far for signal	Do not use the transmitter beyond the control range of 30 metres
Stop point incorrect	The motor was reinstalled	You must reset the stop point after reinstallation
Motor stops halfway	Too much curtain fabric weight	Check the fabric, ensure the weight is within the load capacity
	Fabric blocked	Check if the track or the fabric is blocked or pulled by hand
The system is not working	Cut the power supply for one minute. The system will sometimes restore itself	
Any other malfunction	Please contact your dealer for assistance	

Warranty:

The M500 Motor carries a 3 (three) year warranty from the date of the invoice.

Any malicious damage, incorrect installation or misuse are not covered by the warranty.



Windoware Pty Ltd

QUEENSLAND

40 Parramatta Road, Underwood 4119
Phone (07) 3299 3788 Fax (07) 3299 5120
Email: qldsales@windoware.net.au

NEW SOUTH WALES

7 Tait Street, Smithfield 2164
Phone (02) 9757 1555 Fax (02) 9757 4200
Email: nswsales@windoware.net.au

VICTORIA

9 Lambeck Drive, Tullamarine 3043
Phone (03) 9335 5011 Fax (03) 9338 4822
Email: vicsales@windoware.net.au

SOUTH AUSTRALIA

21A Nelson Street, Stepney 5069
Phone (08) 8363 5544 Fax (08) 8363 2944
Email: sasales@windoware.net.au

TASMANIA

2/14 Lamb Place, Cambridge 7170
Phone (03) 6248 4333 Fax (03) 6248 4334
Email: tassales@windoware.net.au

CANBERRA

3 Sleigh Place, Hume ACT 2620
Phone (02) 6260 1485 Fax (02) 6260 1482
Email: actsales@windoware.net.au

PLEASE NOTE THE FOLLOWING:

- This appliance is not intended for use by persons (including children) with reduced physical, sensory or mental capabilities, or lack of experience and knowledge, unless they have been given supervision or instruction concerning use of the appliance by a person responsible for their safety.
- Children should be supervised to ensure that they do not play with the appliance.
- WARNING: Important safety instructions. Follow all instructions, since incorrect installation can lead to severe injury. SAVE THESE INSTRUCTIONS.
- DO NOT allow children to play with fixed controls. Keep remote controls away from children.
- Frequently examine the installation for imbalance and signs of wear or damage to cables and springs. Do not use if repair or adjustment is necessary.
- If the supply cord is damaged, it must be replaced by the manufacturer, its service agent or similarly qualified persons in order to avoid a hazard.